

## DISASSEMBLY

### 1. REMOVE 2 DUST PROTECTORS

### 2. REMOVE FIELD FRAME AND ARMATURE

- (a) Remove the nut, and disconnect the lead wire from the magnetic switch terminal.

**Torque: 5.9 N·m (60 kgf·cm, 52 in.-lbf)**

- (b) Remove the 2 through bolts.

**Torque:**

**1.4 kW type: 5.9 N·m (60 kgf·cm, 52 in.-lbf)**

**2.0 kW type: 9.3 N·m (95 kgf·cm, 82 in.-lbf)**

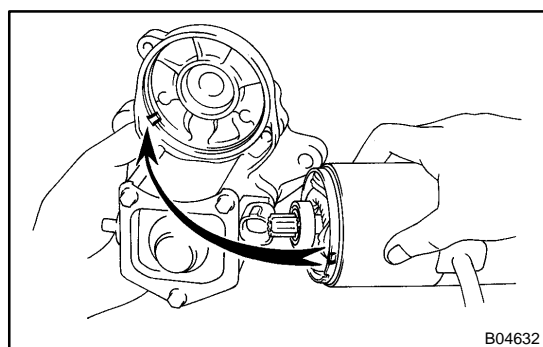

- (c) Pull out the field frame together with the armature from the magnetic switch assembly.

### NOTICE:

**At the time of notice, please refer to the following items.**

**Align the protrusion of the field frame with the groove of the magnetic switch.**

- (d) Remove the O-ring from the field frame.

### HINT:

At the time of assembly, please refer to the following items.

Use a new O-ring.

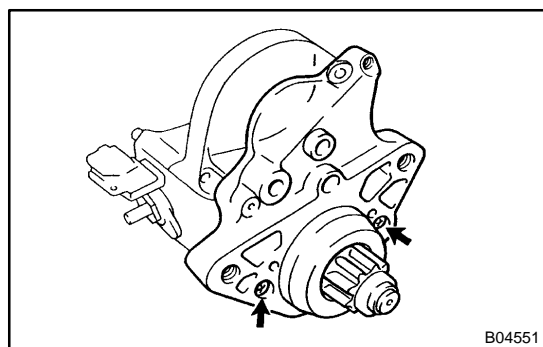

### 3. REMOVE STARTER HOUSING, CLUTCH ASSEMBLY AND GEAR

- (a) 1.4 kW type:

Remove the 2 bolts.

**Torque: 5.9 N·m (60 kgf·cm, 52 in.-lbf)**

- (b) 2.0 kW type:

Remove the 2 screws.

**Torque: 9.3 N·m (95 kgf·cm, 82 in.-lbf)**

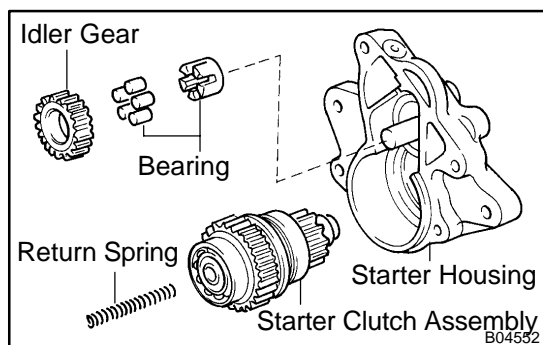

- (c) Remove the starter housing, return spring, idler gear, bearing and starter clutch assembly.

### HINT:

At the time of assembly, please refer to the following item.

Apply grease to the return spring and insert the return spring into the clutch shaft hole.

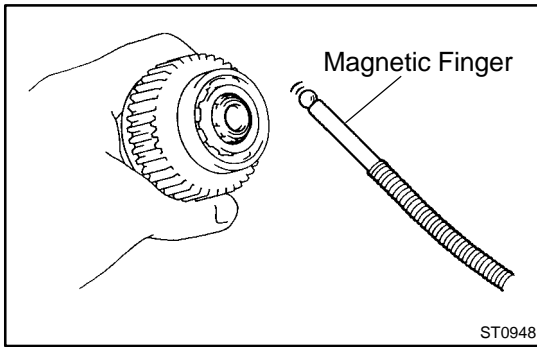

#### 4. REMOVE STEEL BALL

Using a magnetic finger, remove the steel ball from the clutch shaft hole.

HINT:

At the time of assembly, please refer to the following item.  
Apply grease to the steel ball and insert the steel ball into the clutch shaft hole.

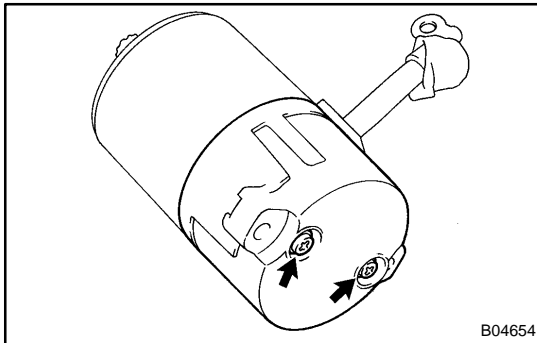

#### 5. REMOVE BRUSH HOLDER

- (a) Remove the 2 screws w/ O-ring and end cover from the field frame.

**Torque:**

**1.4 kW type: 1.5 N·m (15 kgf·cm, 13 in.-lbf)**

**2.0 kW type: 3.8 N·m (39 kgf·cm, 34 in.-lbf)**

- (b) Remove the O-ring from the field frame.

HINT:

At the time of assembly, please refer to the following item.  
Use a new O-ring.

- (c) Using a screwdriver, hold the spring back and disconnect the brush from the brush holder. Disconnect the 4 brushes, and remove the brush holder.

**NOTICE:**

**Check that the positive (+) lead wires are not grounded.**

#### 6. REMOVE ARMATURE FROM FIELD FRAME

